

Guide to Parts for On-body Injector for Neulasta

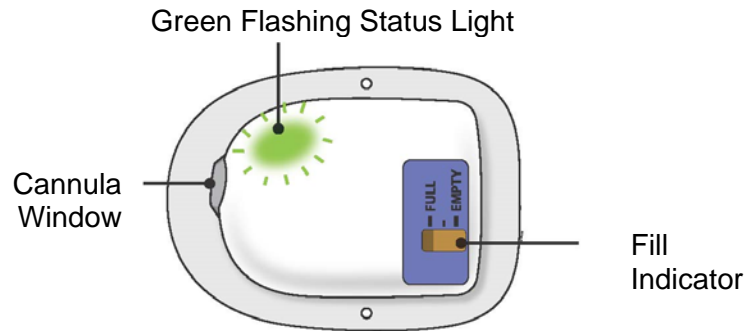

The On-body Injector is working properly.

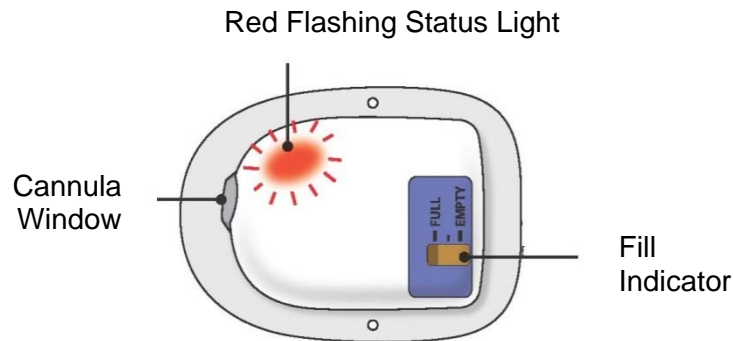

If at any time you hear beeping, check the status light. If it is flashing red, call your healthcare provider immediately.

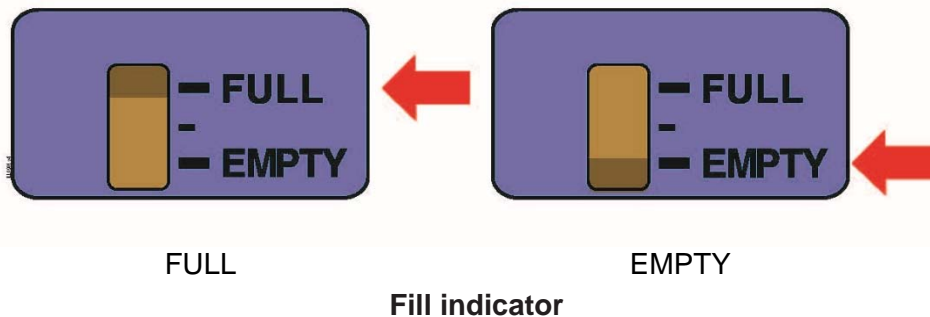

After your dose delivery is complete, check to see if the black line on your On-body Injector fill indicator is at empty.

On-body Injector Placement

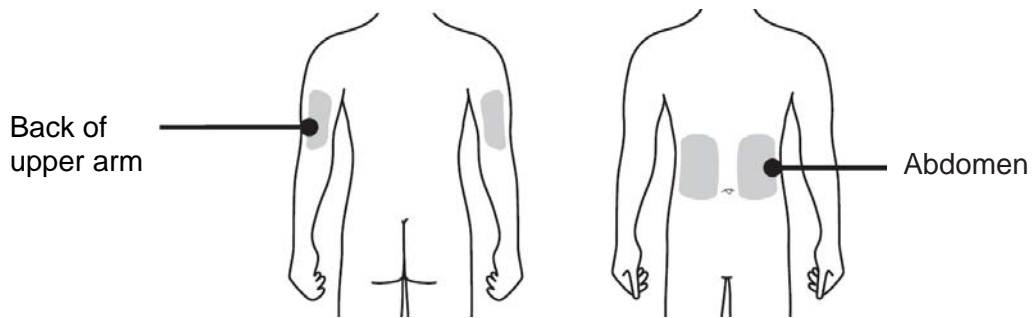

Step 1: Monitor On-body Injector

- A Check your status light occasionally for approximately 27 hours. Since it flashes slowly, watch for at least 10 seconds. If the status light is flashing green, it is okay.**
- If at any time you hear beeping, check the status light. If it is flashing red, call your healthcare provider immediately.

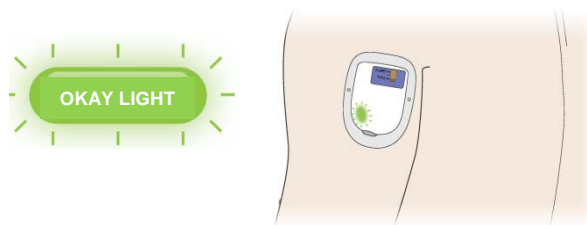

If the On-body Injector for Neulasta was placed on the back of your arm, a caregiver must be available to monitor the status of the On-body Injector.



- B** After approximately 27 hours, your On-body Injector will beep to let you know your dose delivery will begin in 2 minutes. When the dose delivery starts, it will take about 45 minutes to complete. During this time, the On-body Injector will flash a fast green light.
- If at any time you hear beeping, check the status light. If it is flashing red, call your healthcare provider immediately.

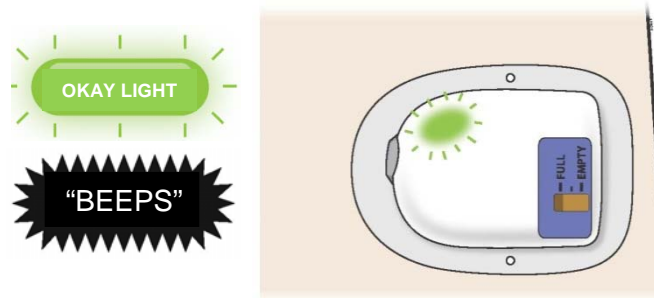

DO NOT remove the On-body Injector before the dose delivery is complete.

Step 2: Monitor Dose Delivery



For the next 45 minutes, monitor your On-body Injector frequently for leaks during dose delivery. If the On-body Injector was placed on the back of your arm, a caregiver must be available to monitor your On-body Injector.

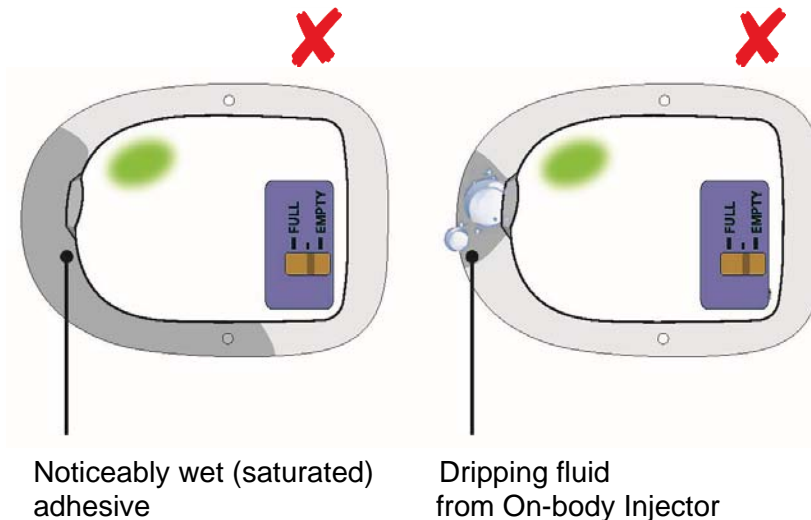

Noticeably wet (saturated) adhesive

Dripping fluid from On-body Injector

If the adhesive becomes noticeably wet (saturated) with fluid, or you see dripping, call your healthcare provider immediately.

A Your dose delivery will take around 45 minutes to complete.

- You may hear a series of clicks. This is okay.
- A beep will sound when the dose delivery is complete.

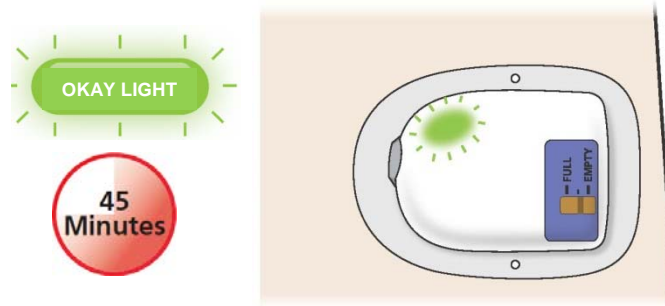

Step 3: Remove On-body Injector When Dose Delivery Is Complete

A When beeping starts, check to see the color of the status light.



Check to see if the status light is SOLID GREEN or has switched off. This means the dose is complete. Remember, **any time you see a leak, call your healthcare provider immediately.** If the dose is complete, go to the next step.

If you see the status light is flashing red, your On-body Injector is not functioning properly. Call your healthcare provider immediately, as you may not have received a full dose.

B Grab the edge of the adhesive pad. Slowly peel off the On-body Injector.

- If medicine has leaked or the adhesive is noticeably wet (saturated), call your healthcare provider immediately as you may not have received your full dose.
- Remove any extra adhesive using soap and water.

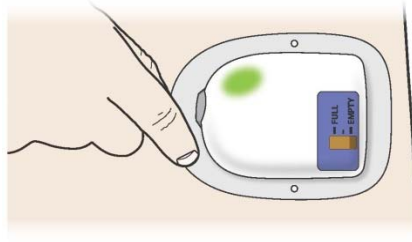

- **Do not** grasp the On-body Injector itself to try to pull it off of your body.

Step 4: Finish



Check to see if your On-body Injector is empty.

- You should see a black line next to the EMPTY indicator. If the On-body Injector is not empty, call your healthcare provider immediately.

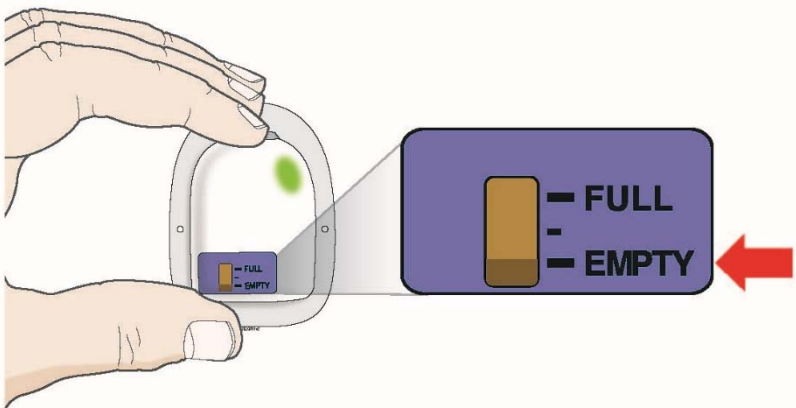

- Check your status light again. Watch for at least 10 seconds. If the status light is solid green or it has switched off, it is okay.
- If you hear beeping, or when you check the status light and it is flashing red, call your healthcare provider immediately.
- After On-body Injector removal, place the On-body Injector in a sharps disposal container whether the needle is exposed or not. If the needle is exposed, call your healthcare provider immediately.

A Record the end state of your On-body Injector.

- Mark the box of the description that represents your On-body Injector after it has been used.

Status light is solid green or the status light has switched off. This means that the delivery is complete.

On-body Injector leaked, call your healthcare provider immediately.

Status light is red, call your healthcare provider immediately.

B Properly dispose of the On-body Injector.

- The On-body Injector contains batteries, electronics, and a needle. Dispose of it in a sharps disposal container as instructed by your healthcare provider or by state or local laws.
- To participate in Amgen's voluntary disposal program, please call 1-844-MYNEULASTA (1-844-696-3852) or visit www.neulasta.com to enroll. For more information about safe sharps disposal, and for specific information about sharps disposal in the state that you live in, go to FDA's website at: <http://www.fda.gov/safesharpsdisposal>.
- Keep children away from the used On-body Injector.

Attention!

What to do if you hear beeping or when you look at the status light and it is flashing red.

- If the status light is flashing red, you may not have received your full dose. Call your healthcare provider immediately.

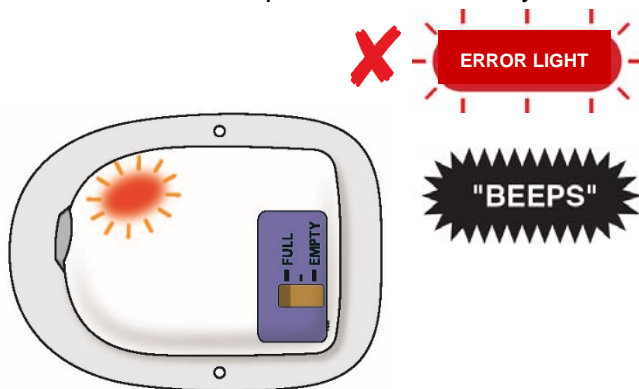

What to do if the On-body Injector adhesive becomes noticeably wet (saturated) with fluid, or you see dripping.

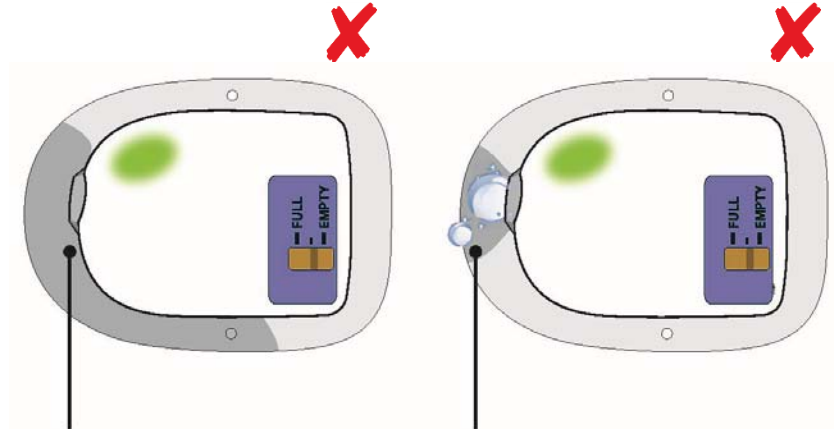

Noticeably wet (saturated) adhesive

Dripping fluid from On-body Injector

- If the adhesive becomes saturated with fluid, or you see dripping, your medicine may have leaked out.
- Even with a leak, the status light may remain green and the fill indicator may be at EMPTY.
- Call your healthcare provider immediately as you may not have received your full dose.

Note: It is normal to see a few drops of fluid at the application site, but not normal to see a noticeably wet (saturated) adhesive.

What do I do if the On-body Injector comes off before the full dose is delivered?

Call your healthcare provider immediately if the On-body Injector at any time comes away from your skin before your full dose delivery, **DO NOT** reapply it.

What if there is blood at my application site after the On-body Injector has been removed?

If there is blood, press a clean cotton ball or gauze pad on the application site. Apply an adhesive bandage if needed.

What if my application site is red or tender after On-body Injector removal?

Call your healthcare provider immediately if you experience persistent or worsening redness or tenderness at the application site, as this can be a sign of infection.



Neulasta® (pegfilgrastim)

Manufactured by:

Amgen Inc.
One Amgen Center Drive
Thousand Oaks, California 91320-1799
US License No. 1080

Patent: <http://pat.amgen.com/onpro/>
© 2002 to 2016 Amgen Inc. All rights reserved.

www.neulasta.com

1-844-MYNEULASTA (1-844-696-3852) Issued: 12/2016 v6